



## OPTIMISED PAINT SYSTEM

# Flexible Paint Cups & Accessories



### Product Information

#### Flexible Paint Cups

	Code	Qty.
125 micron filter 300ml	<b>PSC301</b>	45 sets
190 micron filter 300ml	<b>PSC306</b>	45 sets
125 micron filter 600ml	<b>PSC601</b>	45 sets
190 micron filter 600ml	<b>PSC606</b>	45 sets

#### Accessories

Stoppers	<b>PSS001</b>	100
Rigid Clear Cups 650ml - printed	<b>PSM601</b>	200
Rigid Clear Cups 650ml - blank	<b>PSM606</b>	200

### Product Description

Farécla's Optimised Paint System is an innovative process for the preparation and application of both solvent and water based paints.

Thanks to its robust 2-piece design, paint can be mixed directly in the cup, quickly assembled, used, re-filled and disposed of which guarantees a cost effective job.

### Key Benefits

- Easy to use, store and re-use
- With only 2 pieces to assemble (instead of up to 4), the paint process is speeded up
- With no outer cup required, visibility of the paint remaining in the cup is increased
- Robust gun to cup connection - no chance of breaking
- The closed system means no leaks and allows for inverted spraying in hard to reach areas
- Inverted storage of mixed basecoat prevents the filter from drying out and needing to be replaced. Easy to write on the base of the inverted cup
- Blank Rigid Clear Cups are available for "over the scales" mixing reducing the chance of erroneous mixes
- Reduces costs, and time
- Rigid clear cup stays in the mixing area, reducing the risk of dust contamination in the spray booth
- Disposable system means time saved on cleaning and cost savings on solvents
- Lightweight and low wastage
- Reduces painter fatigue and increases productivity due to a lightweight design
- Whole cup collapses down during use leaving minimum waste disposal

## How to Use

### USE

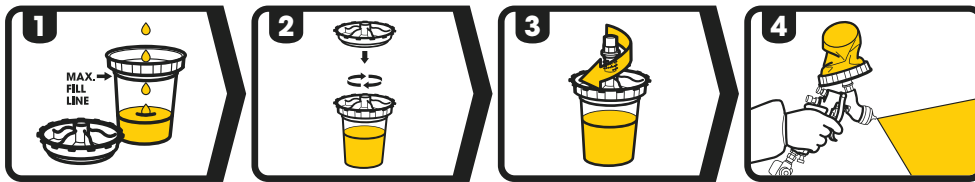

### CAUTION



### STORE



## Use With

Adaptor	Product Code	Spray Gun
Adaptor Type A	PSA00A	Bernardo Eccenaro, Iwata (W-400, WR-400, LPA-94, VXL-949, LPH400), Max-Air, Pro-Tek, SATA (NR 92 HVLP, Jet B GR, Jet GR 92 B, Jet B, Jet B NR 95 HVLP, Jet B NR 92).
Adaptor Type B	PSA00B	Aerometal, Air Gunsa (AR3, AZ3-HTE, AZ30-HTE), Eminent (E13, AZ3 HVLP, AZ3 HET), Iwata (Supernova WS 400), Sagola (Lux).
Adaptor Type C	PSA00C	DeVilbiss (GTi, GTi Pro, PRi, GFP, GFV, GFHV-510, SRI Pro, GTi Pro Lite).
Adaptor Type D	PSA00D	Air Gunsa (AZ4 Serial 75 - primer), Walcom (Geo F/X 97, FX HVLP, Slim).
Adaptor Type E	PSA00E	Kremlin (M21G), SATA (KLC - HVLP/RP/P, MCB family, Jet RP, Jet RP Digital, Jet 2000 HVLP, LM 2000 B, NR 2000 Digital, Jet 90/S), Walcom Genesi.
Adaptor Type F	PSA00F	Sagola, Sagola Mini.
Adaptor Type G	PSA00G	SATA Minijet, Sagola Mini.
Adaptor Type H	PSA00H	Aircraft.
Adaptor Type L	PSA00L	Sagola (4400 Xtreme).
Adaptor Type Q (SATA QCC Adaptor - use with Type E)	PSA00Q	SATA (Jet 2000 +Type E, Jet 3000 +Type E, Jet 4000 +Type E, Jet 5000 +Type E).
Adaptor Type R	PSA00R	DeVilbiss (guns with guages).
Adaptor Type S	PSA00S	Iwata LPH 80 (SMART repair).
Adaptor Type T	PSA00T	DeVilbiss SRI (SMART repair).



Search on YouTube for  
**Farécla Optimised Paint System**

